

BiZ.

BUSINESS INDUSTRY ZONE
HOMEBUSH

161 ARTHUR STREET
UNIT L7 LOT 187

	gross (m ²)
ground floor area	109.00
first floor area	37.00
TOTAL	146.00 m²
car spaces	2.00 spaces

NOTE

All dimensions are approximate only.

All areas shown are gross areas. Strata plan areas will be nett areas, and will be less than the gross areas shown, as external walls, ducts stair voids, etc, will not be included.

Purchasers' attention is directed to special condition 28.9.4 of this contract, which shall prevail.

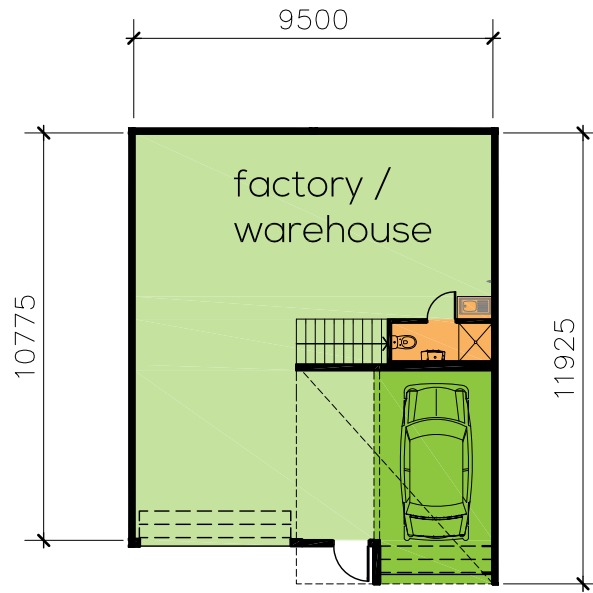

ground floor plan

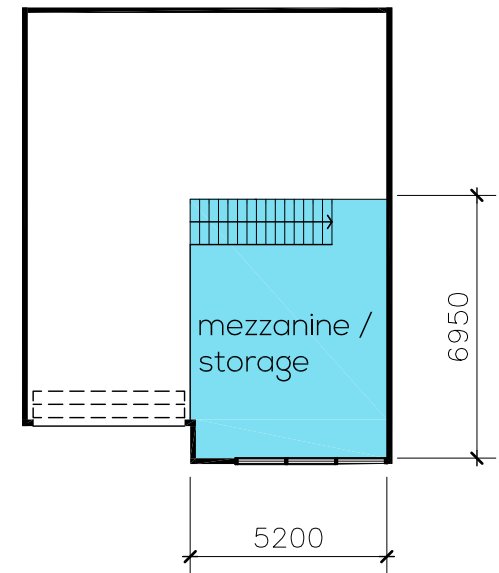

first floor plan

